

\$145,000 - 5024 Lakeview Drive, Rural Lac Ste. Anne County

MLS® #E4438720

\$145,000

0 Bedroom, 0.00 Bathroom,
Rural on 0.00 Acres

Val Quentin, Rural Lac Ste. Anne County, AB

50x150' titled lot located in the quiet community of Val Quentin, just across the street from the boat launch and playground area at lakeside at Lac Ste Anne . This one has a double, oversized garage with r/i bathroom. Power is currently supplied by neighbor so new owner will have to run in their own power. Comes with drilled well (info unknown), municipal sewer, RV Parking with dump, two driveways and a grass front lawn. Can put boat hoist out for the summer just steps away from the property. Great for building your dream home or your recreational get away. Only 40 minutes NW of Edmonton.

Essential Information

MLS® #	E4438720
Price	\$145,000
Bathrooms	0.00
Acres	0.00
Type	Rural
Sub-Type	Vacant Lot/Land
Status	Active

Community Information

Address	5024 Lakeview Drive
Area	Rural Lac Ste. Anne County

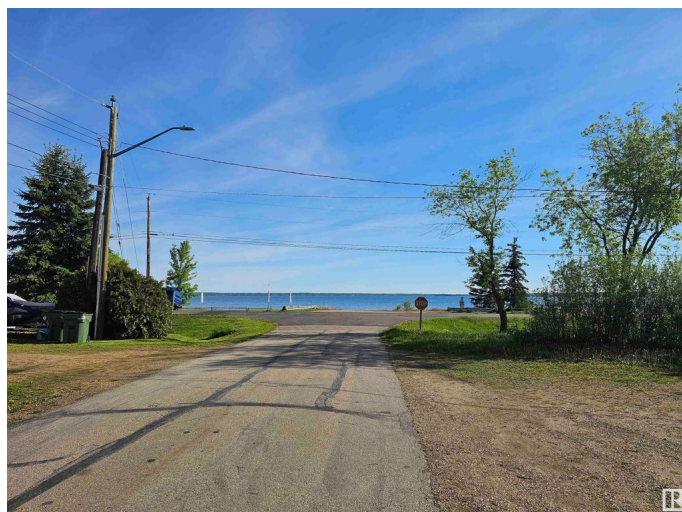

Subdivision	Val Quentin
City	Rural Lac Ste. Anne County
County	ALBERTA
Province	AB
Postal Code	T0E 0A0

Exterior

Exterior Features	Flat Site, Landscaped, No Back Lane, Playground Nearby, Recreation Use
-------------------	--

Additional Information

Date Listed	May 27th, 2025
Days on Market	28
Zoning	Zone 71

DATA IS DEEMED RELIABLE BUT IS NOT GUARANTEED ACCURATE BY THE REALTORS® ASSOCIATION OF EDMONTON. COPYRIGHT 2025 BY THE REALTORS® ASSOCIATION OF EDMONTON. ALL RIGHTS RESERVED. Trademarks are owned or controlled by the Canadian Real Estate Association (CREA) and identify real estate professionals who are members of CREA (REALTOR®, REALTORS®) and/or the quality of services they provide (MLS®, Multiple Listing Service®)

Listing information last updated on June 24th, 2025 at 4:17am MDT